

- 1 Head band cushion
- 2 Slider plastic part
- 3 Support folk
- 4 Control touch pad

- 5 Tilting plastic part
- 6 Charging port
- 7 Ear cushion
- 8 Wire audio input port

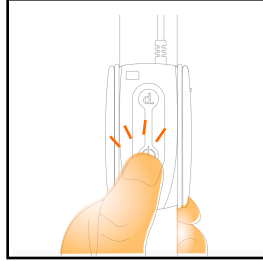

Step 1. Power on transmitter

Make sure the transmitter is fully charged and press the power button for 2 second. The LED indicator will start to flash RED light. The LED indicator will turn to still when connected with any headphones. The headphones and transmitter have been paired before out of factory.

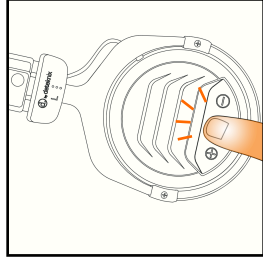

Step 2. Power on headphones

Keep press the power button for 2 seconds to power on. The status LED will start blinking when powered on. The headphones will connect with the last paired transmitter (powered on condition) automatically.

INSTRUCTION MANUAL

WIRE-FREE P_{RO}

SAFETY INSTRUCTIONS

- When wearing the headphones, make sure the volume is turned to minimum. Only adjust the volume after putting the headphones on. Do not turn the volume up too loud. You could cause permanent damage to your hearing.
- Danger to life! Headphones dramatically reduce your ability to hear ambient noise. Using headphones while in road traffic is potentially very dangerous and is therefore prohibited by law. Also, please make sure that you do not use your headphones when in the vicinity of possibly dangerous machines and tools.

This product's wireless 2.4G technology has a transmission range of approx. 10 meters, but interfering obstacles (people, metal objects, walls, etc.), other radio signals, and other factors may affect the transmission range or even loss connection. Avoid to place the transmitter close to your cell phone.

HEADPHONES ADJUSTMENT

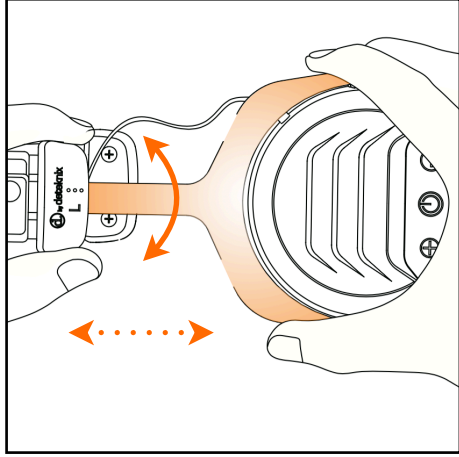

Before wearing the Wire-Free Pro headphones for the first time you should adjust it properly to achieve the best sound and ambient noise attenuation. A proper way of wearing will reduce the fatigue of your ear.

As shown in the figure : Pull or push to select the appropriate lock-in position on both sides of the headphones folk. The dot will help you memorize the position for next time adjustment. The ear pads will tilt automatically according to your head size.

Note: The folks are made of aluminium to offer light weight and durability. Please do not bend it with force intently

HEADPHONES CONTROL

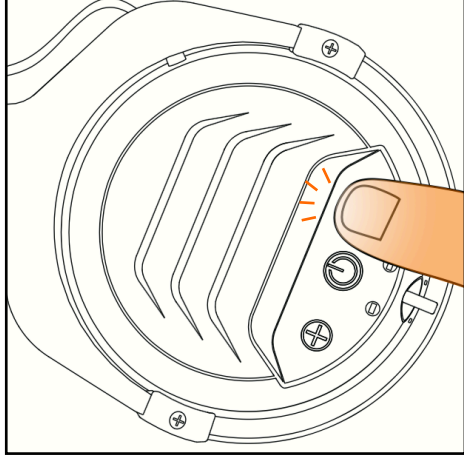

Volume control

Single click on +/- button to increase or decrease volume by one segment. Keep press on +/- button to adjust volume faster.

Pairing (if necessary)

When the headphones is not connected with the last transmitter it will blink at a fast frequency. You just need to press the headphones power button once quickly near the new transmitter (powered on condition). The headphones LED will blink at a slow frequency when pairing successfully.

Battery status reading

You can press the power button twice quickly to read the battery condition.

Green LED : 80%~100% ; Amber:60%~80%

RED: 30%~60% (please charge)

TAKE OFF WATERPROOF BUDS

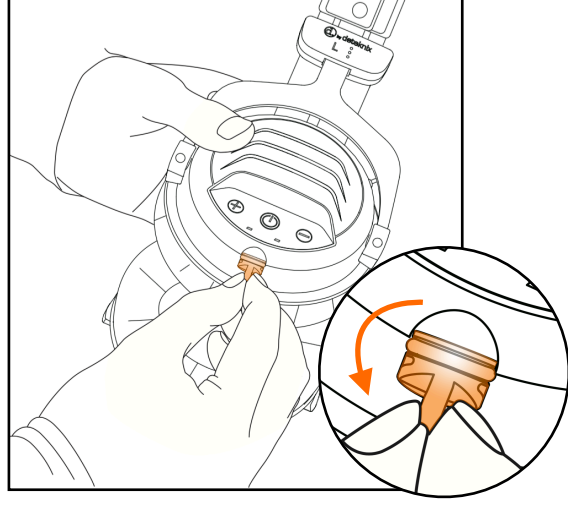

Take off the rubber bud on the power control side of headphones will help to deliver the best bass sound quality. Hold the arm of the bud as illustrated and pull it out gently.

Please insert them back when working in raining condition to prevent moisture get into headphones electronic house.

Note: clean the rubber O ring and apply lubricant routinely to keep the sealing in perfect condition.

RECHARGING TRANSMITTER

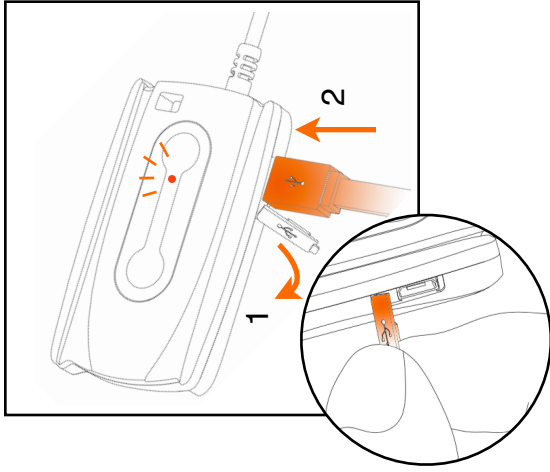

Take off the rubber insert on the side of transmitter. You can recharge it through the dual output stock charger, smartphone charger (recommend), laptop computer USB port, or power bank for emergency. Plug the USB side into the port and insert the micro USB head on the transmitter's charging port. The LED indicator will start to flash and it will turn off when fully charged.

TRANSMITTER ATTACHMENT

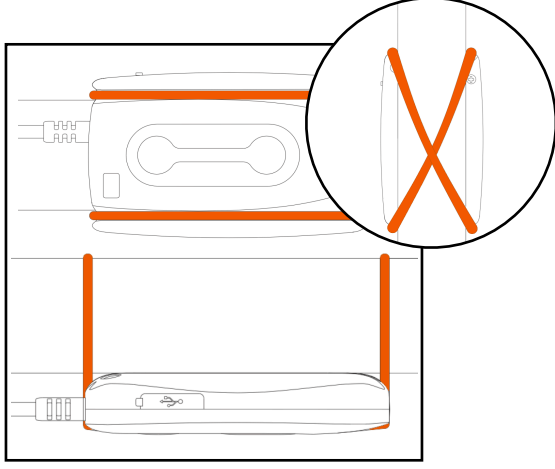

Place the transmitter near the detectors' audio jack on the rod. Wrap the elastic band from the button of rod and hold on the gap of transmitter. If the rod is too thin, twist the elastic band first and follow the above process. Don't stretch the spring cord too much to prevent the wire broke.

TROUBLE SHOOTING & MAINTENANCE

Problems	Solution
Loss signal randomly	Make sure the transmitter and headphones been fully charged
Headphones or transmitter Do not power on	Make sure the devices been fully charged
Powered on but no sound from headphones	Make sure the transmitter is securely connected with the detector. Increase the volume.

Don't Do This

Avoid extreme shock and harsh treatment, because it can degrade the life of the product.

Do not use a sharp object to clean the device.

Clean the devices with fresh water after exposure to chlorine, salt water, sunscreen, cosmetics, alcohol, or other harsh chemicals. Prolonged exposure to these substances can damage the case.

Do not place in high temperature, such as directly sun exposure position.

Don't twist or pull transmitter's cord directly. Grab the connector to pull.

Cleaning the Device

1 Make sure all waterproof buds or insert are securely in position and wipe the devices using a cloth dampened with clean tap water. **2** Wipe them dry.

RECHARGE & WIRE CONNECTION

Headphones recharging

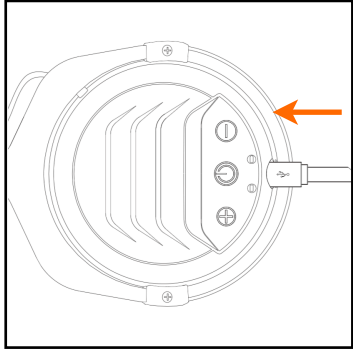

Wire audio cord connection

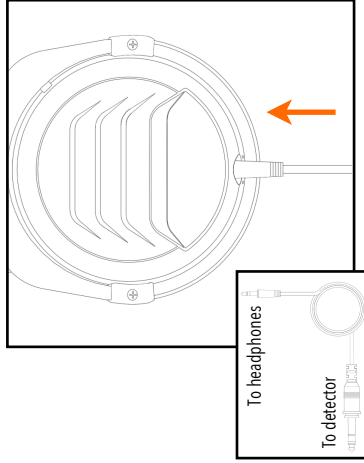

EXCHANGE HEADBAND CUSHION

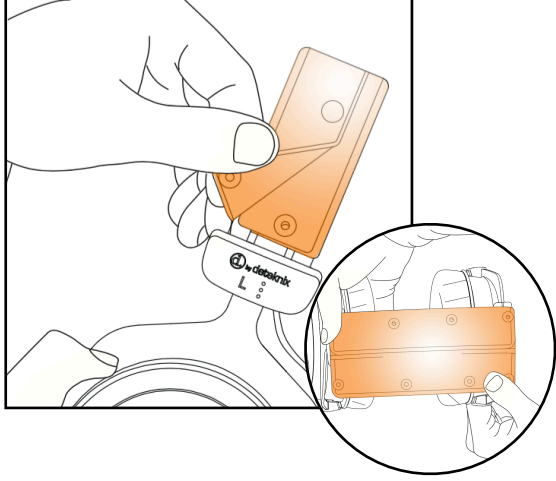

You can take off the head band cushions for cleaning or replace with new one. Hold the edge of the cushion and pull from the first button.

When wear it back to the headphone, start place the center of cushion under the head band and wrap it to the top. Press and secure four buttons.

EXCHANGE EAR CUSHION

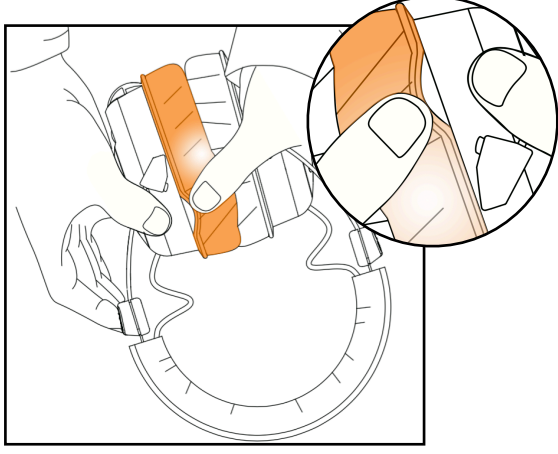

You can take off the ear cushions for cleaning or replace with new one. Peer off the side rim of ear cushion and pull the entire one off from the headphone.

When wear it back to the headphone, start from a small part, turn the cushion while hold the matched part.